

XGQT18 Flange Adaptor PN16

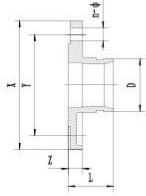

Nominal Size mm/in	Pipe O.D mm/in D	Working Pressure PSI/MPa	Dimensions mm/in				Bolt Size No.-Size mm	UL	FM
			L mm/in	X mm/in	Y mm/in	Z mm/in			
50	60.3	230	60.3	165	125	19	4-M16	•	•
2	2.375	1.6	2.37	6.496	4.92	0.748	4-M16	•	•
65	73.0	230	60.3	185	145	19	4-M16	•	•
2½	2.875	1.6	2.37	7.283	5.70	0.748	4-M16	•	•
65	76.1	230	60.3	185	145	19	4-M16	•	•
2½	3.000	1.6	2.37	7.283	5.70	0.748	4-M16	•	•
80	88.9	230	60.3	200	160	19	8-M16	•	•
3	3.500	1.6	2.37	7.874	6.29	0.748	8-M16	•	•
100	108.0	230	70	220	180	19	8-M16	•	•
4	4.250	1.6	2.755	8.661	7.08	0.748	8-M16	•	•
100	114.3	230	70	220	180	19	8-M16	•	•
4	4.500	1.6	2.755	8.661	7.08	0.748	8-M16	•	•
125	133.0	230	60.3	250	210	19	8-M16	•	•
5	5.250	1.6	2.37	9.842	8.26	0.748	8-M16	•	•
125	139.7	230	60.3	250	210	19	8-M16	•	•
5	5.500	1.6	2.37	9.842	8.26	0.748	8-M16	•	•
125	141.3	230	70	250	210	19	8-M16	•	•
5	5.563	1.6	2.755	9.842	8.26	0.748	8-M16	•	•
150	159.0	230	70	285	240	19	8-M20	•	•
6	6.250	1.6	2.755	11.22	9.448	0.748	8-M20	•	•
150	165.1	230	70	285	240	19	8-M20	•	•
6	6.500	1.6	2.755	11.22	9.448	0.748	8-M20	•	•
150	168.3	230	70	285	240	19	8-M20	•	•
6	6.625	1.6	2.755	11.22	9.448	0.748	8-M20	•	•
200	219.1	230	76.1	340	295	20	12-M20	•	•
8	8.625	1.6	2.99	13.38	11.61	0.748	12-M20	•	•
250	273.0	230	85	405	355	22	12-M20	•	•
10	10.750	1.6	3.346	15.944	13.97	0.866	12-M20	•	•
300	323.9	230	90	460	410	24.5	12-M20	•	•
12	12.750	1.6	3.543	18.11	16.14	0.96	12-M20	•	•
350	377.0	230	100	520	470	26	16-M24		
14	14.843	1.6	3.937	20.47	18.50	1.02	16-M24		

The specific items list shall be subject to the public notice of FM and UL website.