

XGQT02

Flexible Coupling

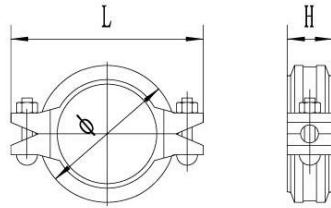

Our flexible coupling can accommodate misalignment, distortion, thermal stress, vibration, noise and seismic tremors. It even accommodate an arced or curved piping layout. The specific items list shall be subject to the public notice of FM and UL website.

Nominal Size mm/in	Pipe O.D mm/in	Working Pressure PSI/MPa	Bolt Size No.-Size mm	Dimensions mm/in			UL	FM
				Ø	L	H		
25 1	33.7 1.327	500 3.45	2-M10x45	60 2.362	98 3.858	43.5 1.713	•	•
32 1¼	42.4 1.669	500 3.45	2-M10x45	67 2.638	106 4.173	44 1.732	•	•
40 1½	48.3 1.900	500 3.45	2-M10x45	73 2.874	108 4.252	44 1.732	•	•
50 2	60.3 2.375	500 3.45	2-M10x55	87 3.425	123 4.843	44 1.732	•	•
65 2½	73.0 2.875	500 3.45	2-M10x55	100 3.937	138 5.433	44 1.732	•	•
65 2½	76.1 3.000	500 3.45	2-M10x55	103 4.055	142 5.591	45 1.772	•	•
80 3	88.9 3.500	500 3.45	2-M12x60	117 4.606	166 6.535	45 1.772	•	•
100 4	114.3 4.500	500 3.45	2-M12x65	139 5.472	190 7.480	49 1.929	•	•
125 5	139.7 5.500	400 2.75	2-M12x75	168 6.614	218 8.583	49 1.929	•	•
150 6	165.1 6.500	400 2.75	2-M12x75	193 7.598	241 9.488	49 1.929	•	•
150 6	168.3 6.625	400 2.75	2-M12x75	198.5 7.815	249 9.803	50 1.969	•	•
200 8	219.1 8.625	300 2.07	2-M16x85	253 9.961	320 12.598	59 2.323	•	•
250 10	273 10.748	300 2.07	2-M22x130	317 12.48	401 15.787	63 2.48	•	•
300 12	323.9 12.752	300 2.07	2-M22x130	375 14.764	455 17.913	64 2.52	•	•
350 14	355.6 14	300 2.07	3-M22x130	418 16.457	508 20	74 2.913		
400 16	406.4 16	300 2.07	3-M22x130	467 18.386	567 22.323	78 3.071		
400 16	425.5 16.752	300 2.07	2-M22x130	486 19.134	580 22.835	78 3.071		